



Hewlett Packard

Santa Rosa, CA

Project Size

20,160 sq ft

Construction

IBC Type V

Protected

Contract Type

Design-build

Stipulated sum

Facility Use

Office / Technology

Center

Description

Wood and steel frame-work

Simulated stucco exterior

Seismic foundation design

Completion

110 days

Traditional
Modular
Construction

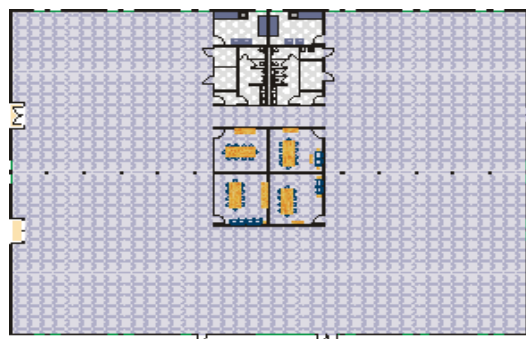
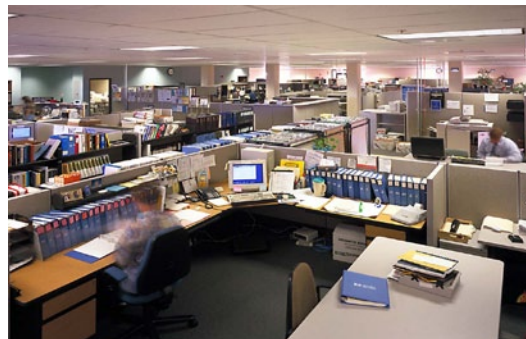

To support a rapid expansion program Hewlett Packard turned to Ramtech for construction of this 20,160 square foot office / research center for the support of new integrated circuit technology. The Type V wood structure was designed, manufactured and erected in 110 days.

RAMTECH
Building Systems
800-568-9376
ramtechmodular.com